

fullwat[®]

professional *solutions*

ISSIA-DWxx-Bx-MX/D Series

AirFlat Multi-purpose Mini Panel

- Fast Installation
- Thin
- Universal

2 in 1

Recessed &
Surface-mounted

Recessed

Surface-mounted

SUPER SLIM 15MM

ELEGANT CURVE

2 in 1 *Recessed & Surface-mounted*

Recessed ▼

1 18W D230mm

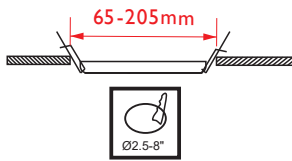

Fit all cut-out from
65-205mm (2.5"-8")

2 12W D180mm

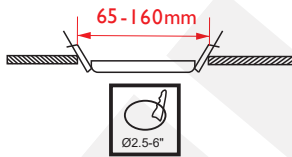

Fit all cut-out from
65-160mm (2.5"-6")

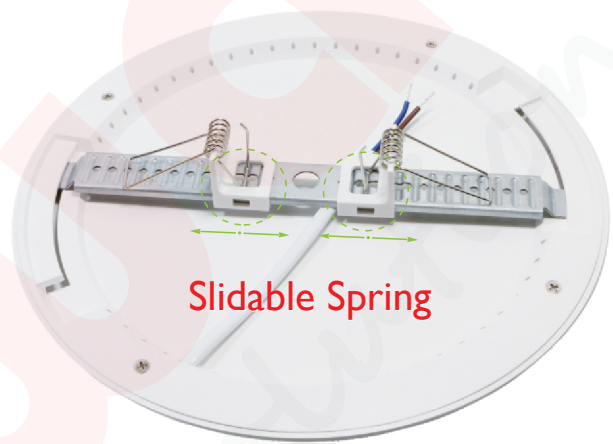

Surface-mounted ▼

EASY & FAST installation

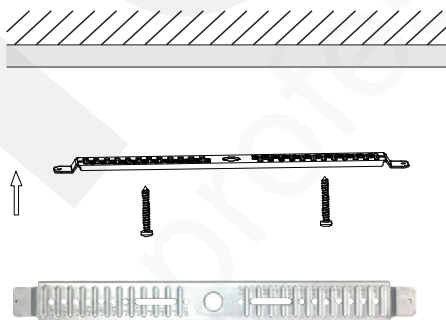

Easy surface-mounted

→  Twist on to lock



18W

IP40



15mm Thickness < 2x

Ultra-thin
Compact & elegant design



Flicker-free.



DOB driver-side design, saving installing space.

Technology Parameter

Reference	ISSIA-DW18-Bx-MX	ISSIA-DW18-Bx-MX/D	ISSIA-DW12-Bx-MX	ISSIA-DW12-Bx-MX/D
Diameter (A/B mm)	D230x15mm	D230x15mm	D180x15mm	D180x15mm
Thickness(mm)	15mm	15mm	15mm	15mm
Watt (W)	18W	18W	12W	12W
LED Qty (pcs)	90PCS	90PCS	78PCS	78PCS
Voltage (V)	AC220-240V	AC220-240V	AC220-240V	AC220-240V
Lumens (lm)	1300-1500lm	1300-1500lm	840-1100lm	840-1100lm
Light Efficacy (lm/W)	75-85lm/w	75-85lm/w	70-85lm/w	70-85lm/w
CCT (K)	2700K/3000K/4000K/6000K			
CRI (Ra)	80	80	80	80
Beam Angle (°)	120°	120°	120°	120°
Dimmable	No	Yes	No	Yes
Power Factor (PF)	0.5	0.5	0.5	0.5
Lifetime (Hrs)	30,000	30,000	30,000	30,000

Application for commercial lighting (office, hotel, shopping mall, museum, hospital etc.)
Residential lighting (bedroom, hall, dining room, kitchen etc.)



ISSIA-DW18-BC

Light distribution: symmetry lighting
CCT : 3000K
Dimension: Ø230x15mm
Beam angle: 120°

Notice:

The testing data can only represent 18W AirFlat in CCT 3000K

The testing data of above luminous intensity distribution curve is from Shenzhen LCS Compliance Testing Laboratory.

LUMINOUS INTENSITY DISTRIBUTION

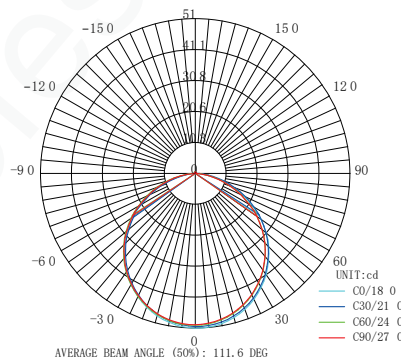

LUMINOUS INTENSITY DISTRIBUTION

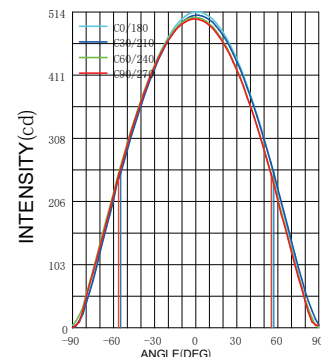

◉ Dimension (mm)

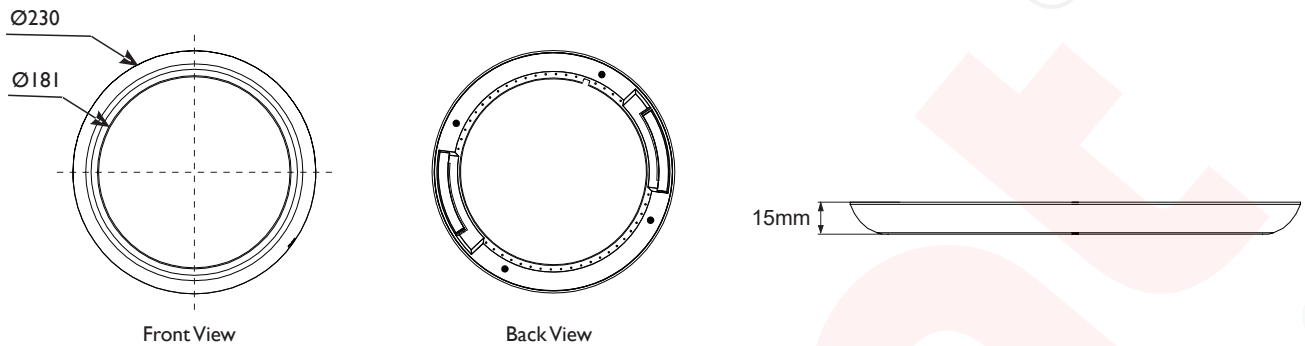

◉ Structure Drawing

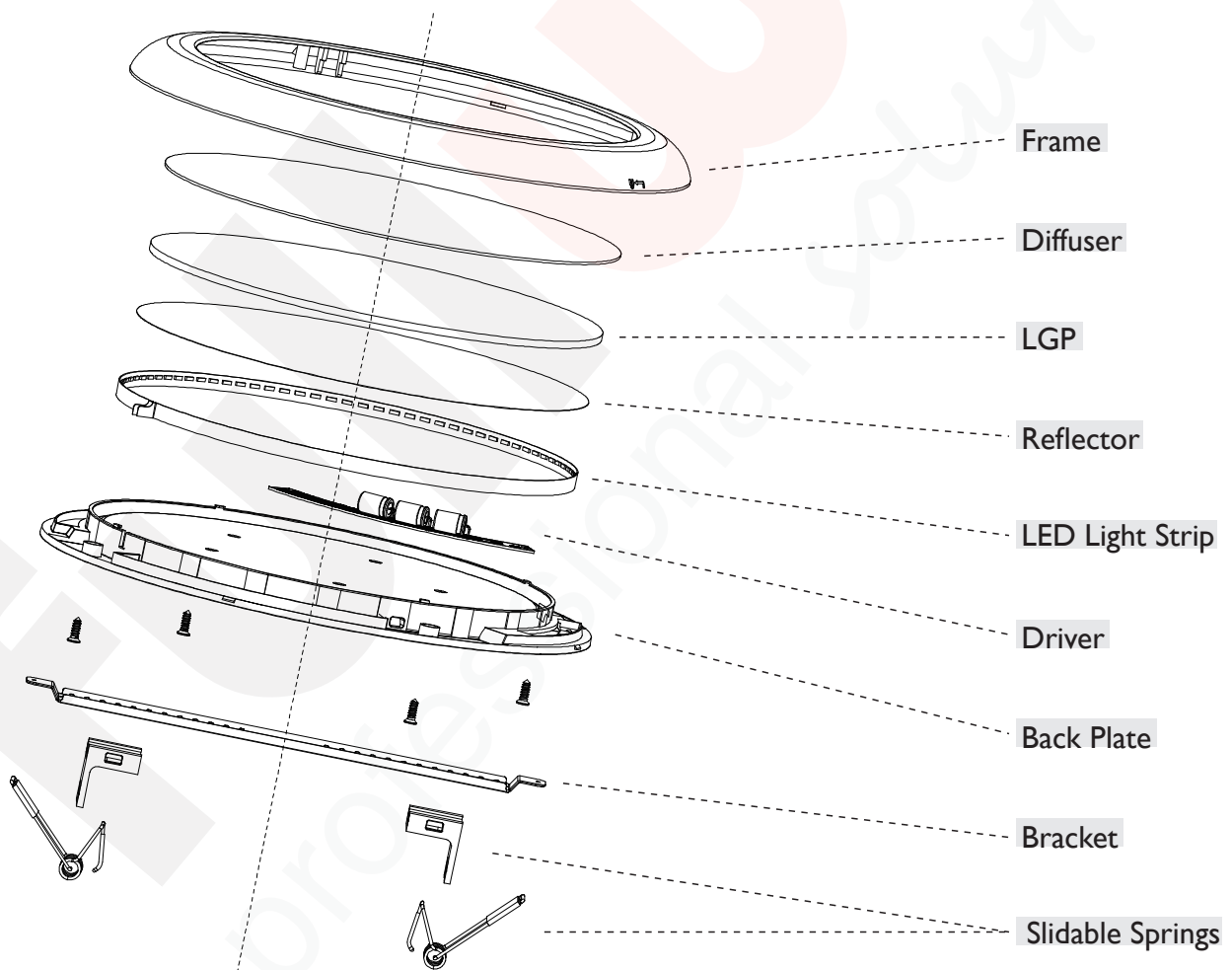

Installation Instruction

Please read these instructions thoroughly before use and retain for future reference.

- Make sure the power is off before installation.
- This product is suitable for connection to a 220- 240Vac 50/60Hz supply.
- Installation must be carried out in accordance with national building and wiring regulations.
- Only the professional electrician can do the installing work. (Watch out the high voltage!)
- Make sure the integrity of the panel light when open the package.
- There is at least 0.2mm distance between the lamp and the inflammable materials.
- The power line can be fixed by clips and need to make sure it is fixed tightly.
- Make sure the power line get enough length to avoid any pull force of the line.
- After installation, link the lamp with driver.
- Link the drive to electric supply, usually, the brown line is firing line, the blue line is null line.
- Do not use the drive specially for LED lamp on other lamps.

Recessed

Notice: Spring adjustable instruction

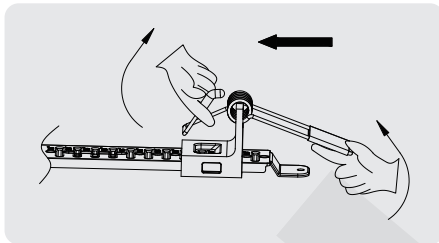

Pull the spring and push in

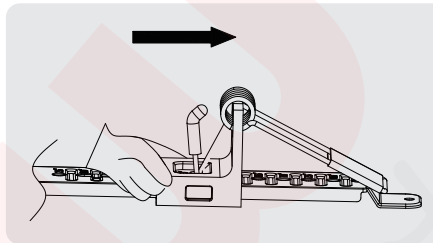

Push out directly

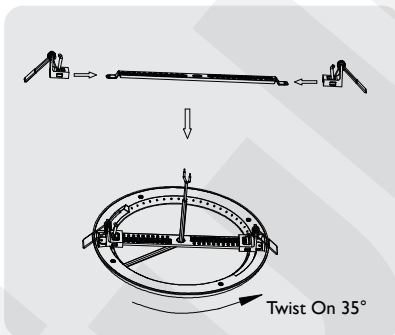

Step1: Install the spring to the bracket. Ensure the spring stay at the suitable position according to the ceiling hole size. Install the bracket to panel.

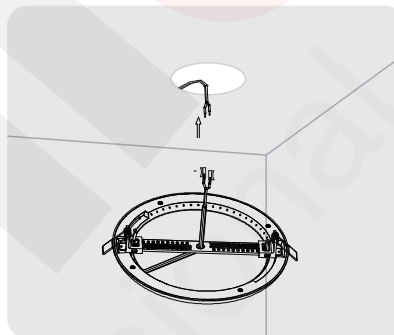

Step2: Connect the lamp's the power cable;

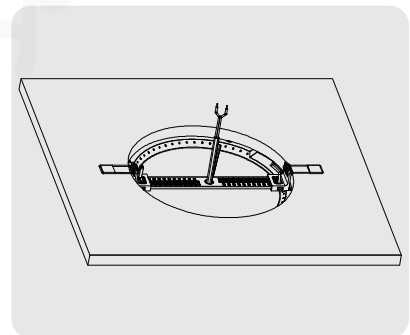

Step3: pick up the spring and install the fitting to ceiling hole.

Surface-mounted

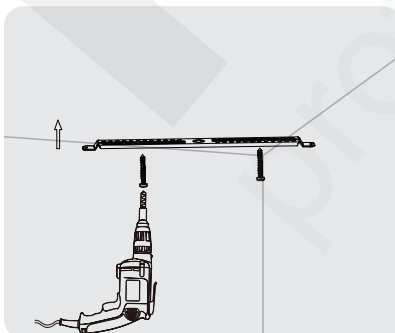

Step1: Fix the bracket on the ceiling;

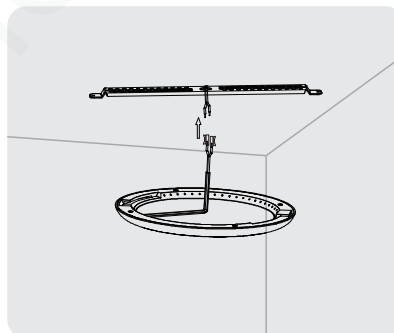

Step2: Connect the lamp's the power cable;

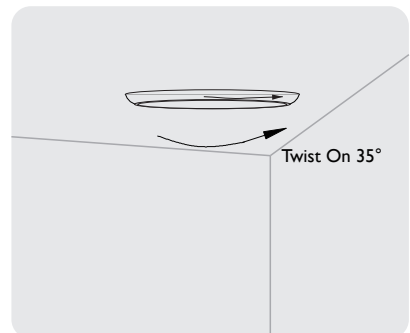

Step3: Twist on the fitting

⇒ Package

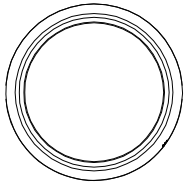

LED Light

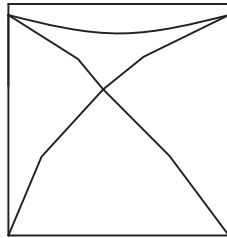

PE Bag

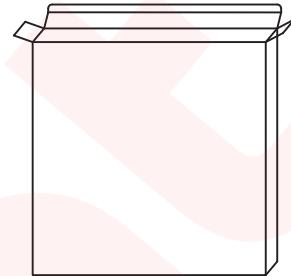

BOX

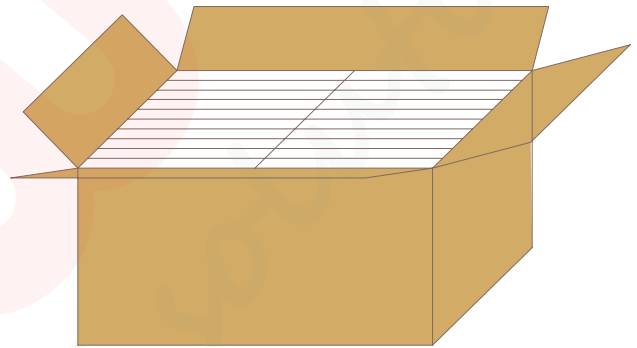

Carton

Package List:

- 1x AirFlat
- 1x Bracket
- 2x Slidable Springs
- 2x Screw-kits

Item \ Model	18W (-D)	12W (-D)
Box Size	275x239x30mm	225x190x30mm
Qty / Box	1 pcs	1 pcs
Carton Size	498x320x305mm	400x270x305mm
Qty / Carton	20pcs	20pcs
G.W.	11Kg	9.5Kg
Qty / 20GP	11200	17000
Qty / 40GP	22800	34500

Note: there may be tolerance on weight, please check with us for details.