



Professional Series Led Strips

CVIC-5060-RGBX-(W)X

SMD5050 constant voltage dimmable LED strip 60 led/m



Product Features

- Super brightness SMD 5050 LEDs.
- Cutttable for each group.
- Longer in connection, uniform brightness.
- DC24V, safe and fit for universal use.
- Many patents approved.

Applications

- Decoration for showcase, ultra-slim light box, hotel, store and advertising board decoration.
- Decoration for bridge, road and garden.
- Decoration for ceiling, furniture, car etc.
- Flexible, especially suitable for construction which asks for especial lighting.

* LM80 CERTIFIED:
LED LIFESPAN tested under LM80;
Expected LIFETIME of 30.000h.

CVIC-5060-RGBX-(W)X

Professional series



SMD5050 Constant Voltage Dimmable Strip

60 Led/m 13 W/m 24V Warranty up to 7 years

≤930 lm/m LED SMD 5050 FINE MIXING SUPER BRIGHT

For:
CVIC-5060-RGBC-(W)X
CVIC-5060-RGBN-(W)X
CVIC-5060-RGBF-(W)X

CRI >90 standard

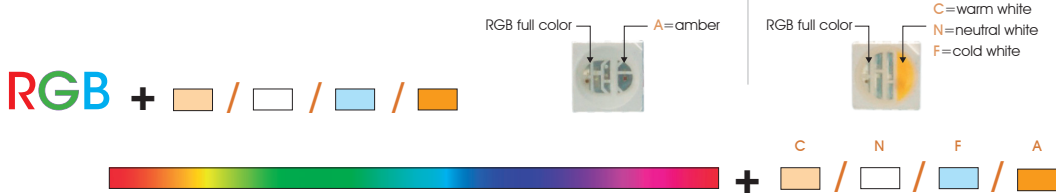

5 Max. meters in series (one side powered) VHB 3M driver NOT included 120° 5m 16.66mm 10cm 30.000 h

10 Max. meters in series (two side powered) ADF PCB Do not bend ESD Dimmable Alu profile required Working 50°C / -20°C Storage 60°C / -40°C

Features

Part number	CCT / wavelength	Luminous intensity per m / flux	Efficiency lm / W	Energy efficiency	Ordinary strip	Strip with waterproof part number "W" suffix
CVIC-5060-RGBA-(W)X	(R) 625-630nm (G) 520-525nm (B) 465-470nm (A) 585-595nm	±600lm	±46	G	 	 No color temperature deviation.
CVIC-5060-RGBC-(W)X	(R) 620-630nm (G) 515-530nm (B) 460-470nm (BC) 3000k	±870lm	±67	G		
CVIC-5060-RGBN-(W)X	(R) 620-630nm (G) 515-530nm (B) 460-470nm (BN) 4500k	±895lm	±69	G		
CVIC-5060-RGBF-(W)X	(R) 620-630nm (G) 515-530nm (B) 460-470nm (BF) 6500k	±930lm	±72	G		

Notes

Waterproof led strips covered by silicone material use to suffer an unavoidable CCT value modification owing to optical effect caused when light beam passes through material.
Initial CCT values are increased several hundreds or thousands of °K. This increasing is much higher in coldest white CCTs.
New FULLWAT molded silicone system avoids this effect and our waterproof led strips are CCT rated at original value without modification.
Please, contact with your local sales office to get wider details.

25m 25 length models are available.

50m 50 length models are available under request. Contact to our Sales Department.

Specific parameters

Reference	Waterproof materials	Size (mm)	Transmittance Rate	Outlet Way (single end or double ends)	Mode of fixation	Accessories	IP Rate
CVIC-5060-RGBX-WX	Solid silicone tube	14x4	92%	Wire	3M adhesive tape	Wire	IP67
CVIC-5060-RGBX-X	Non waterproof	12x1.25	100%	Wire	3M adhesive tape	Wire	IP20

Performance curve

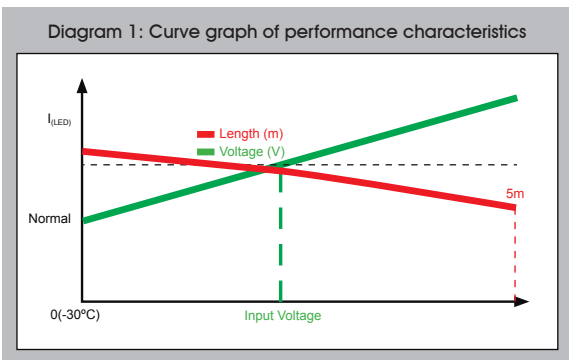

1. Working Voltage

In order to ensure the product performance, the input voltage precision should be within 5%, or it would lead to the brightness unbalance and effect the lifespan of the product. Working voltage curve: green curve.

2. Working Voltage

In order to ensure the product performance, the suggested length is 5m through bilateral input. Long distance connection should be parallel. Unilateral input or overlength would lead to brightness unbalance.

Curve Line

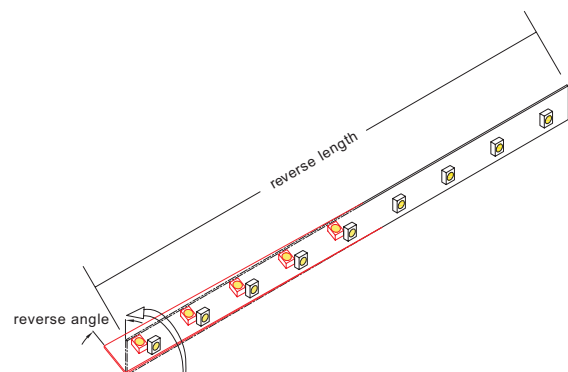
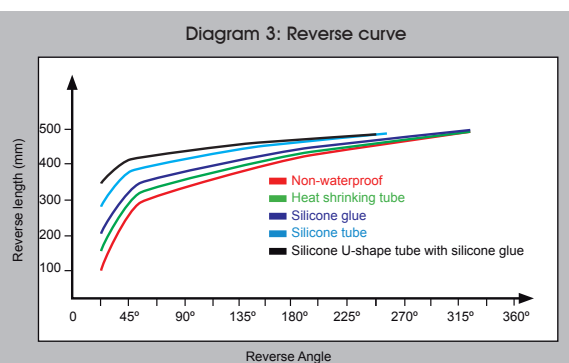
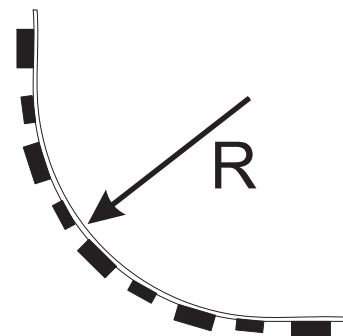
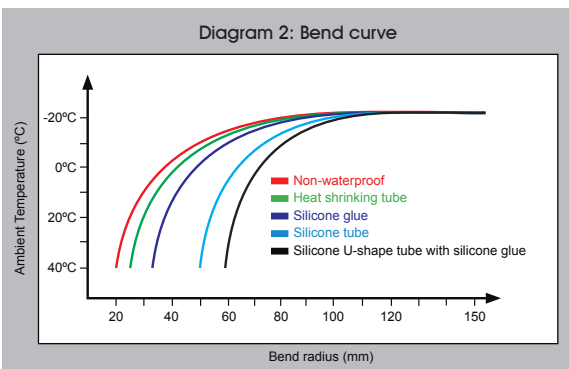

For reference, parameter in the diagram is tested with 0°Celsius temperature.

■ **NON WATERPROOF MODEL**

Features

- With 3M VHB adhesive tape, it is easy for installation, IP20.
- Small in size, light in weight, flexible..

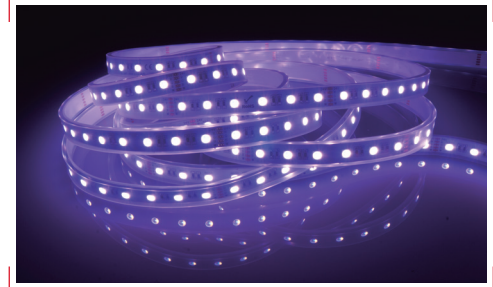

Operation Specification

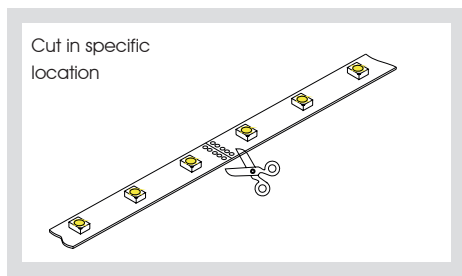

Product size

Front View

Units: mm

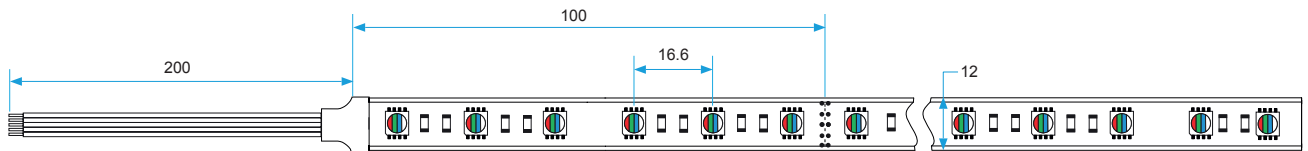

Side view

Units: mm

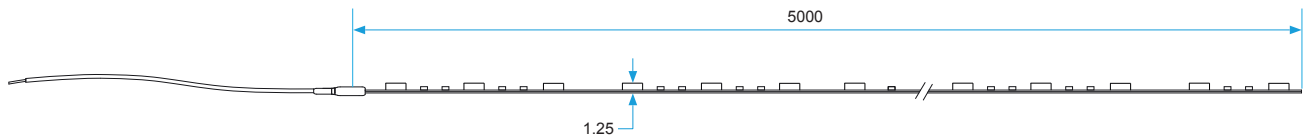

WATERPROOF MODEL

Features

- The strip is well protected by silicone tube IP67.
- High temperature resistance high flexibility, anti UV, high light transmittance ($\geq 92\%$), non-toxic.

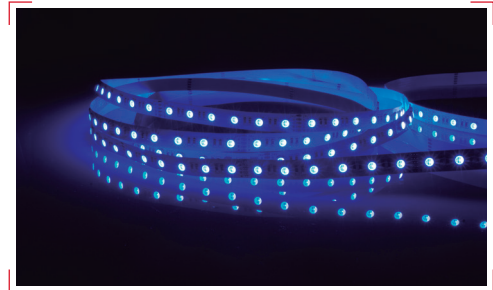

Accessories



Screws



Silicone clip



Wire



End cap

Operation Specification

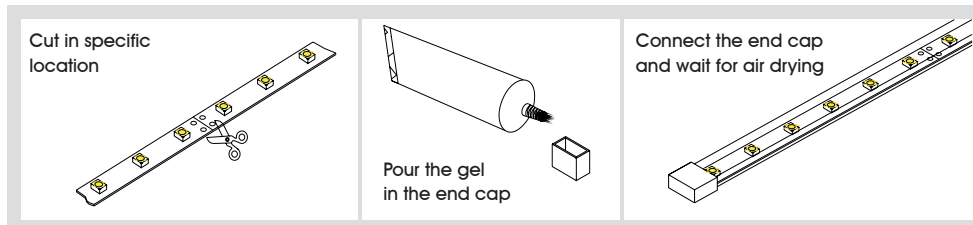

Product size

Front view

Units: mm

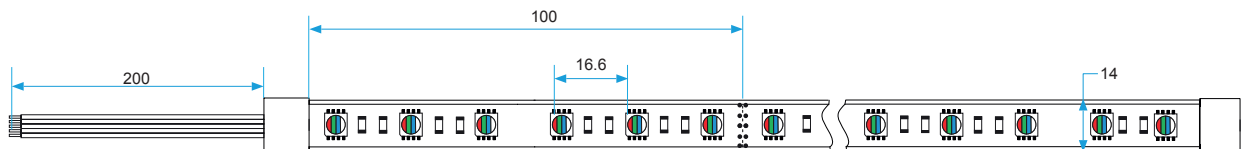

Side view

Units: mm

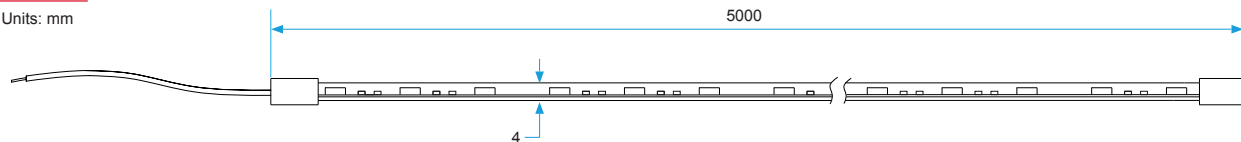

■ **CONNECTION DIAGRAMS**

RGBW Strip Dimming
Dimmable option

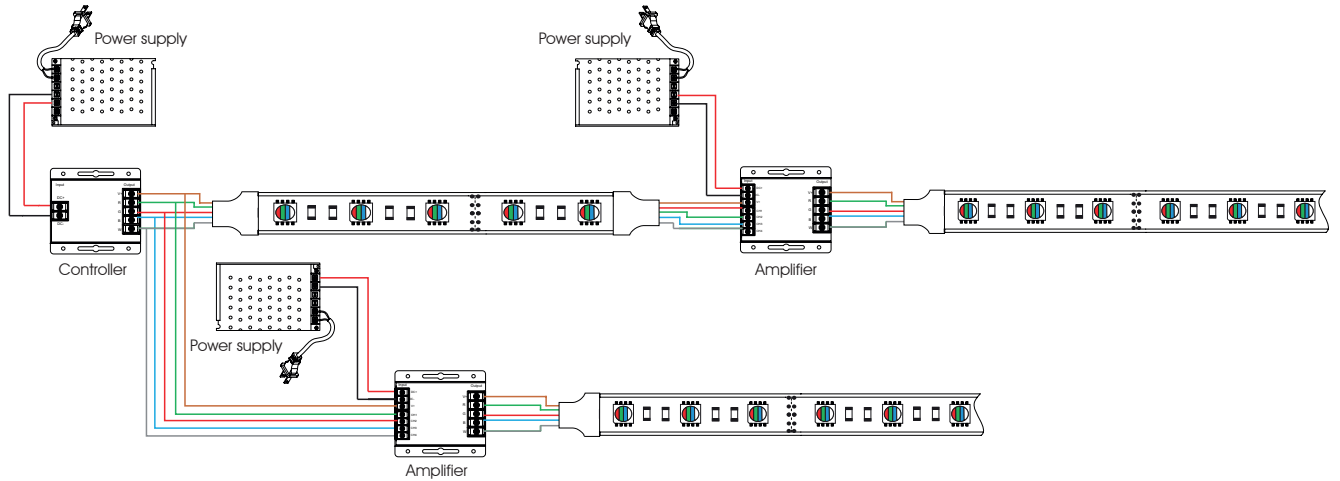

■ **INSTALLATION**

Adhesive 3M VHB

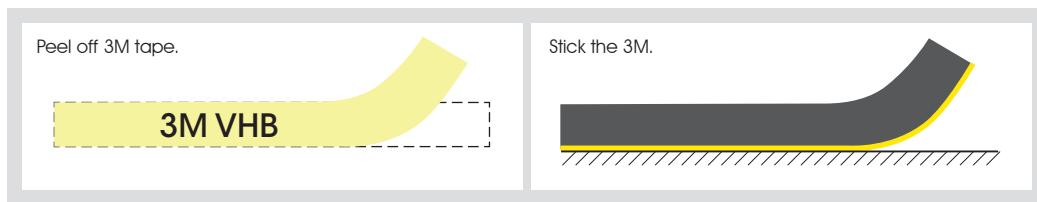

Clips and screws

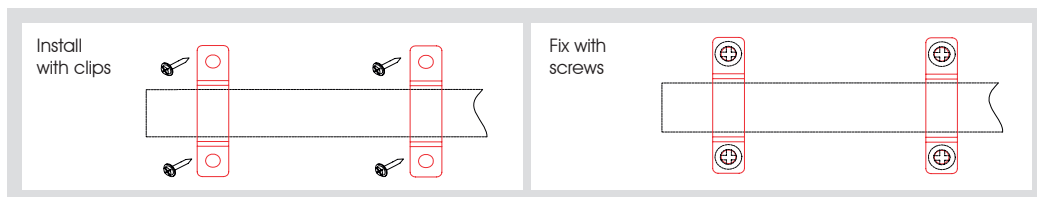

■ **PACKAGING**



■ **NOTES**

1. Please apply different IP rate products according to different environment conditions.
2. Adopt suitable power supply to match the LED strips. Power is 30% bigger than max power of LED strips to ensure long time performance of power supply.
3. Do not install it when power is on. Before powering on, please make sure the wiring is correct.
4. Avoiding changing or damaging the circuit or other component on the strip.
5. Avoid dragging, over bending in installation.
6. In order to get the best lighting effect, please do not connect overlong.
7. Please do not stare at the light for a long time when it is working to protect your eyes.
8. Only professional personnel may dismantle and repair.