

## Professional Series Led Strips

CVIC-5060-RGBFC-(W)X

SMD5050 constant voltage dimmable LED strip 60 led/m



### Product Features

- Super brightness SMD 5050 LEDs.
- Cutttable for each group.
- Longer in connection, uniform brightness.
- DC24V, safe and fit for universal use.
- Many patents approved.

### Applications

- Decoration for showcase, ultra-slim light box, hotel, store and advertising board decoration.
- Decoration for bridge, road and garden.
- Decoration for ceiling, furniture, car etc.
- Flexible, especially suitable for construction which asks for especial lighting.

\* LM80 CERTIFIED:  
LED LIFESPAN tested under LM80;  
Expected LIFETIME of 30.000h.

CVIC-5060-RGBFC-ESP(W)X

Professional series



SMD5050 Constant Voltage Dimmable Strip

60  
Leds/m

17  
W/m

24V

Warranty up to  
**7**  
Years

≤1840  
lm/m

LED SMD  
5050

standard  
CRI  
>80

FINE  
MIXING

SUPER  
BRIGHT

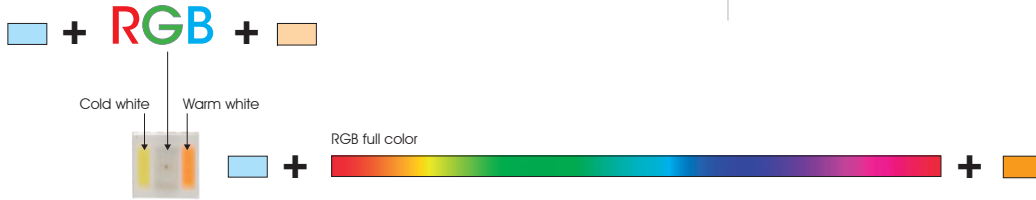

5 Max. meters in series  
(one side powered)

**VHB  
3M**

driver  
**NOT**  
included

120°

5m

16,66mm

10cm

30.000 h

10 Max. meters in series  
(two side powered)

Do not bend

ESD

Dimmable

Alu profile  
suggested

Working  
50°C  
-20°C

Storage  
60°C  
-40°C

Features

Part number	CCT / wavelength	Luminous intensity per m / flux	Efficiency lm / W	Energy efficiency	Ordinary strip	Strip with waterproof part number "W" suffix
CVIC-5060-RGBFC-(W)X	(R) 620-625nm	±1840lm	±108		 5000mm 1,25mm 12mm	 5000mm 4mm 14mm  No color temperature deviation.
	(G) 520-530nm					
	(B) 465-470nm					
	(BC) 2400k					
	(BF) 6500k					

Notes

Waterproof led strips covered by silicone material use to suffer an unavoidable CCT value modification owing to optical effect caused when light beam passes through material.  
Initial CCT values are increased several hundreds or thousands of °K. This increasing is much higher in coldest white CCTs.  
New FULLWAT molded silicone system avoids this effect and our waterproof led strips are CCT rated at original value without modification.  
Please, contact with your local sales office to get wider details.

25m  
25 length models are available.

50m  
50 length models are available under request.  
Contact to our Sales Department.

Specific parameters

Reference	Waterproof materials	Size (mm)	Transmittance Rate	Outlet Way (single end or double ends)	Mode of fixation	Accessories	IP Rate
CVIC-5060-RGBFC-WX	Solid silicone tube	14x4	92%	Wire	3M adhesive tape	Wire	IP67
CVIC-5060-RGBFC-X	Non waterproof	12x1.25	100%	Wire	3M adhesive tape	Wire	IP20

Performance curve

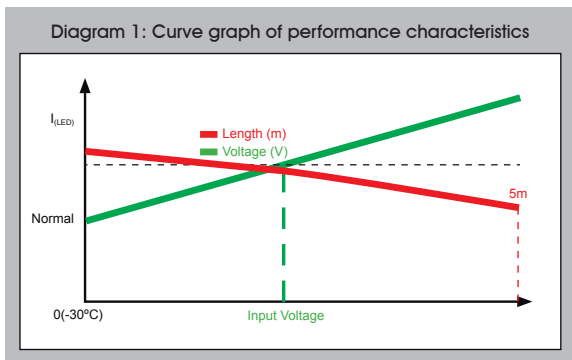

1. Working Voltage

In order to ensure the product performance, the input voltage precision should be within 5%, or it would lead to the brightness unbalance and effect the lifespan of the product. Working voltage curve: green curve.

2. Working Voltage

In order to ensure the product performance, the suggested length is 5m through bilateral input. Long distance connection should be parallel. Unilateral input or overlength would lead to brightness unbalance.

Curve Line

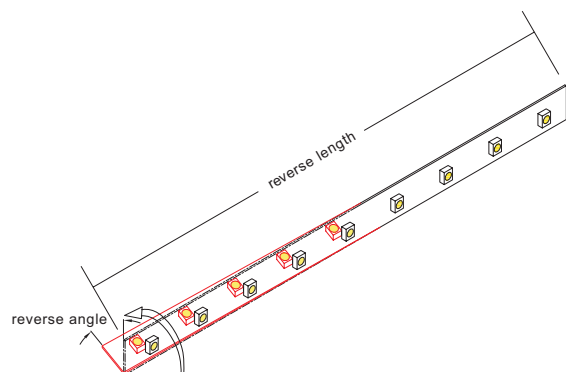
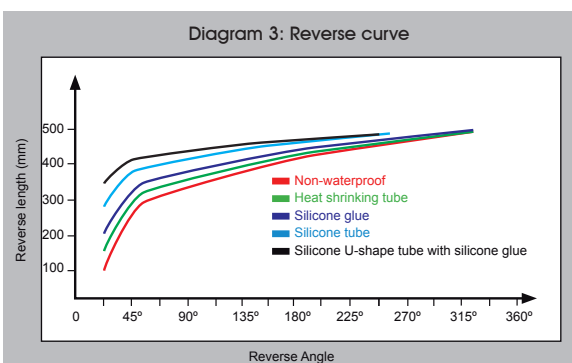
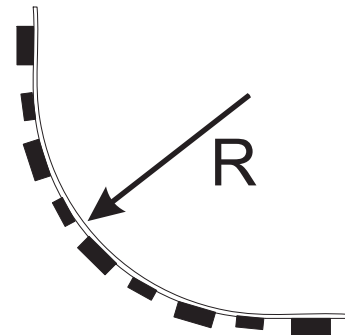
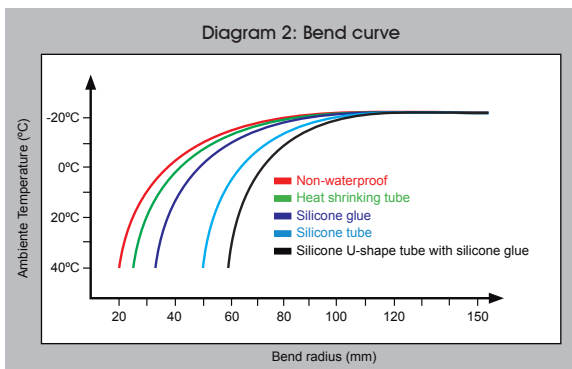

For reference, parameter in the diagram is tested with 0°Celsius temperature.

■ **NON WATERPROOF MODEL**

Features

- With 3M VHB adhesive tape, it is easy for installation, IP20.
- Small in size, light in weight, flexible..

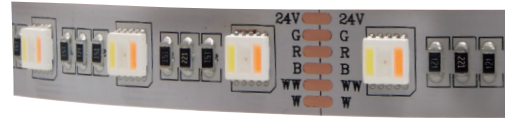

Operation Specification

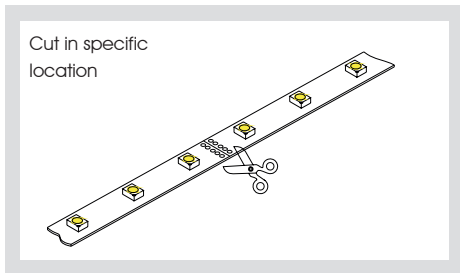

Product size

Front View

Units: mm



Side view

Units: mm

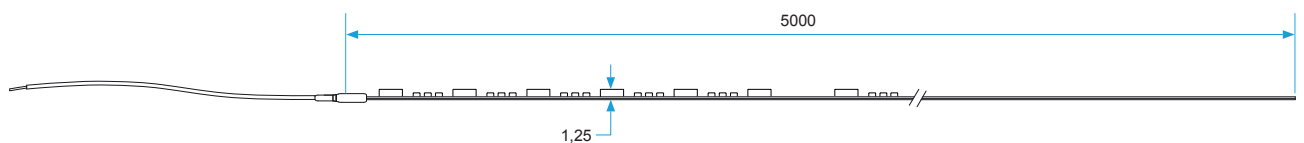

**WATERPROOF MODEL**

Features

- The strip is well protected by silicone tube IP67.
- High temperature resistance high flexibility, anti UV, high light transmittance ( $\geq 92\%$ ), non-toxic.

Accessories



Screws



Silicone clip



Wire



End cap

Operation Specification

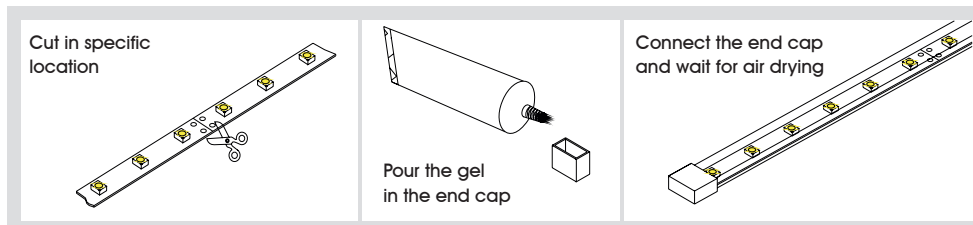

Product size

Front view

Units: mm

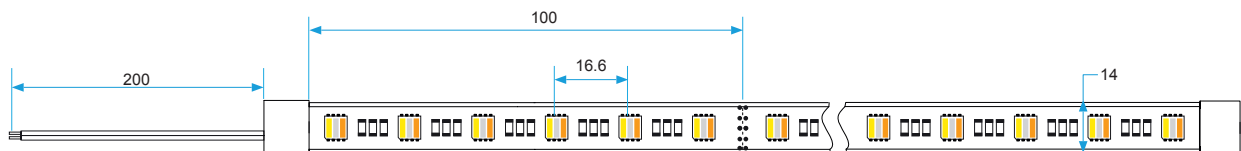

Side view

Units: mm

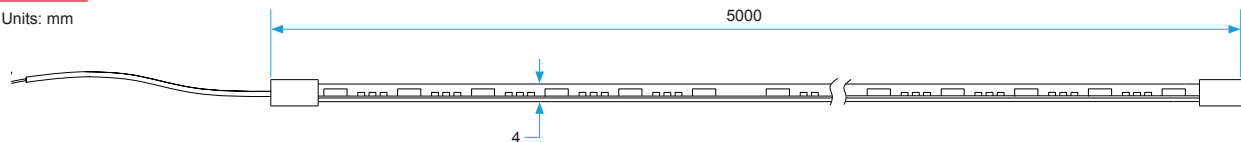

**CONNECTION DIAGRAMS**

RGBW Strip Dimming

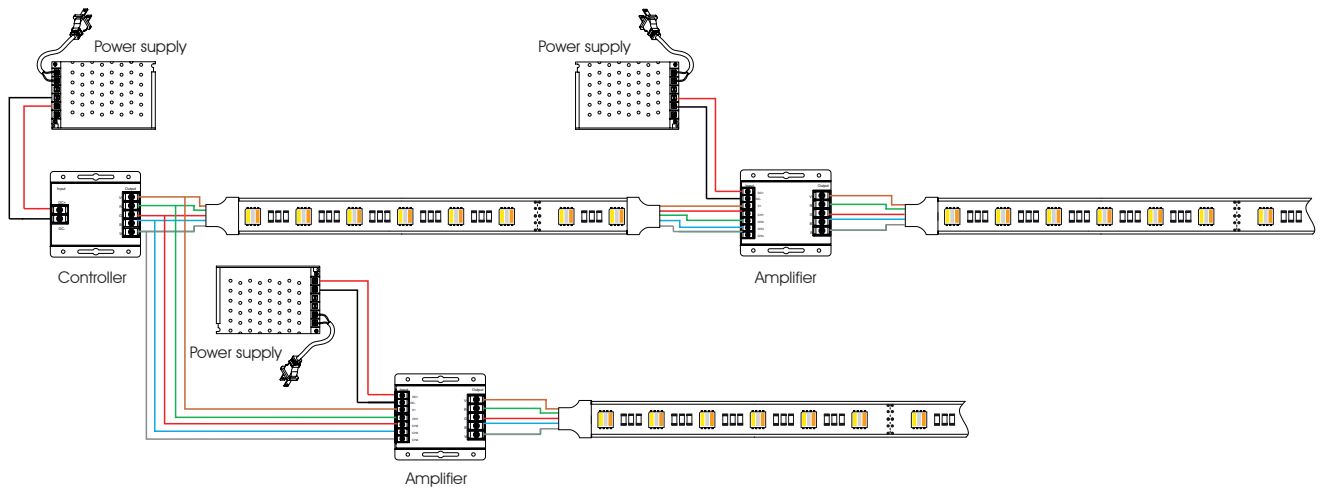

**INSTALLATION**

Adhesive 3M VHB

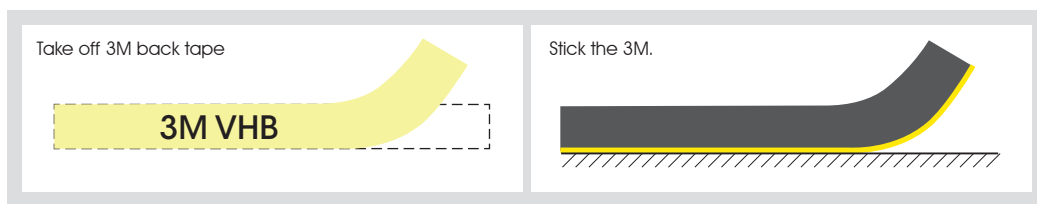

Clips and screws

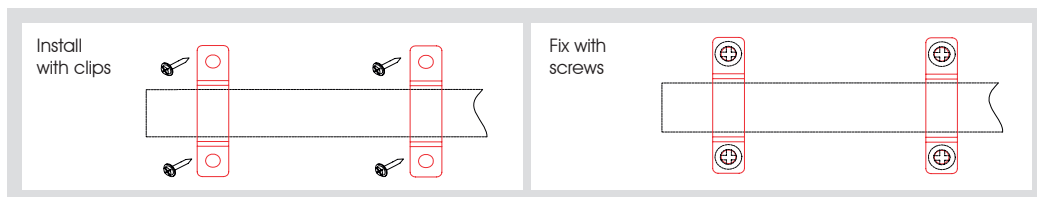

■ **PACKAGING**



■ **NOTES**

1. Please apply different IP rate products according to different environment conditions.
2. Adopt suitable power supply to match the LED strips. Power is 30% bigger than max power of LED strips to ensure long time performance of power supply.
3. Do not install it when power is on. Before powering on, please make sure the wiring is correct.
4. Avoiding changing or damaging the circuit or other component on the strip.
5. Avoid dragging, over bending in installation.
6. In order to get the best lighting effect, please do not connect overlong.
7. Please do not stare at the light for a long time when it is working to protect your eyes.
8. Only professional personnel may dismantle and repair.