

# UL 2.4 - 12

12V 2.4AH

STANDBY

# Ultrace//<sup>®</sup>

'Quality in Every Language'

## Image



## Terminal Type

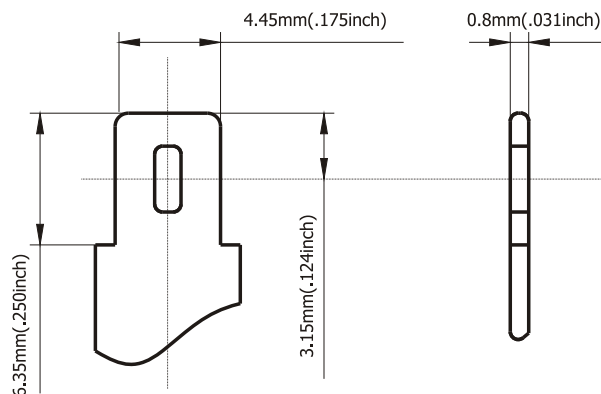

## Dimensions

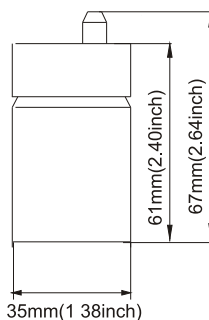
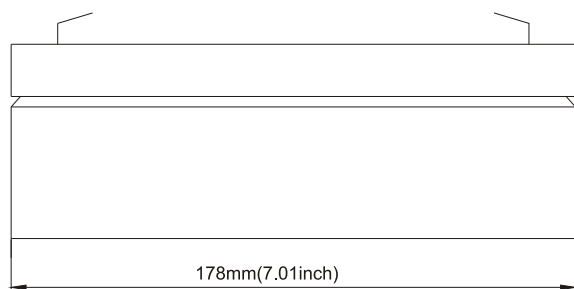

## Specifications

Battery Model	UL 2.4 - 12			
Designed Floating Life	5 Years			
Capacity (25°C)	20HR (0.12A, 1.75V)	10HR (0.228A, 1.75V)	5HR (0.408A, 1.75V)	1HR (1.44A, 1.55V)
	2.4AH	2.28AH	2.04AH	1.44AH
Dimensions	Length	Width	Height	Total Height
	178mm	35mm	61mm	67mm
Approx. Weight	1Kg			
Internal Resistance	Fully Charged at 25°C 0.046 Ohm			
Self Discharge	3% of capacity declined per month at 25°C			
Capacity Affected by Temperature	40°C	25°C	0°C	-15°C
	102%	100%	85%	65%
Charge Voltage (25°C)	Cycle Use		Float Use	
	14.0-15.0V (-24mV/C), max. Current: 0.72A		13.6-13.8V (-18mV/C)	

## Construction

Component	Raw material	Sealant	Epoxy Resin
Positive	Lead dioxide	Safety Valve	EPDR
Negative	Lead	Terminal	Copper
Container	ABS (Flame Retardent optional)	Separator	Fibre Glass
Cover	ABS (Flame Retardent optional)	Electrolyte	Sulphuric acid

Sealed and maintenance free option

Non-spillable construction design



**UKAI BILBAO**  
 Ribera Elorrieta 7C  
 48015 Bilbao  
 Teléfono: 94 474 5252  
 Fax: 94 475 9710  
 e-mail: ukai@ukai.com

**UKAI BARCELONA**  
 Avda. Vallcarca 74-76  
 08023 Barcelona  
 Teléfono: 93 284 0898  
 Fax: 93 210 6765  
 e-mail: ukaibcn@ukai.com

**UKAI MADRID**  
 Avda Andalucía 2, 2ª planta local 211  
 28700 San Sebastián de los Reyes  
 Teléfono: 91 659 0328  
 Fax: 91 659 0558  
 e-mail: ukaimad@ukai.com

# UL 2.4 - 12

12V 2.4AH

STANDBY

# Ultracell®

'Quality in Every Language'

## Charge Characteristic

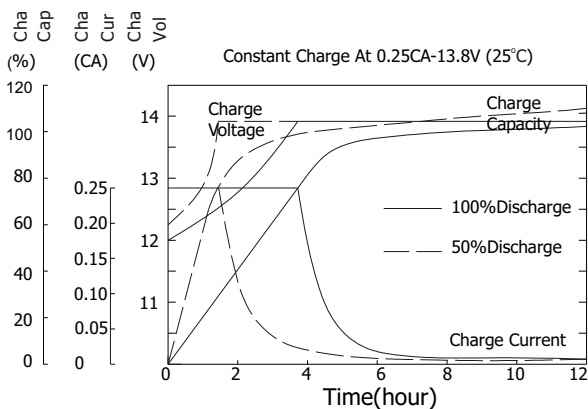

## Discharge Characteristic 25°C

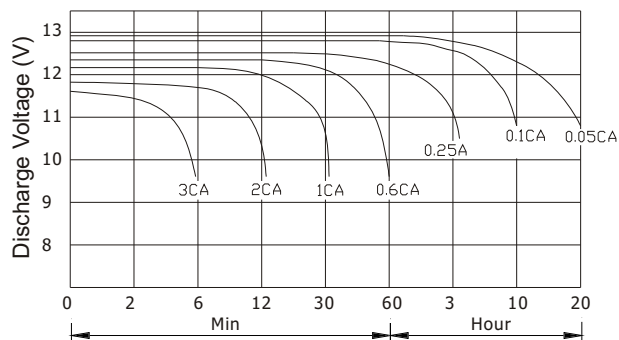

## Relationship of OCV and state of charge

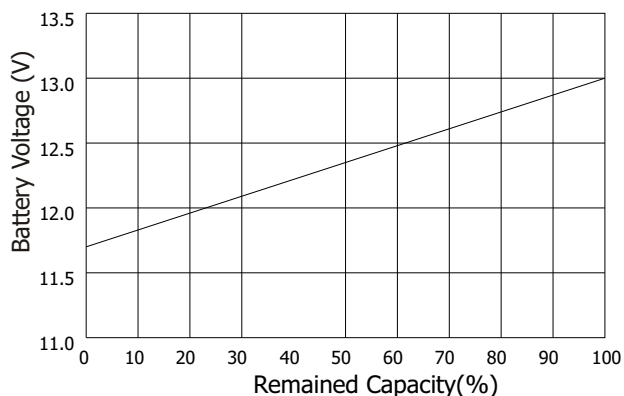

## Self Discharge Characteristics

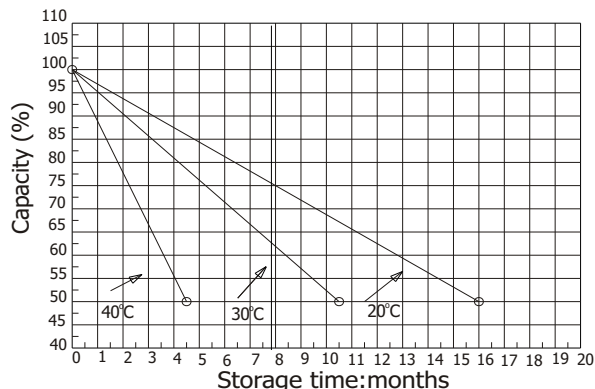

## Constant Current Discharge Ratings - amperes at 25°C

F.V / Time	5 MIN	10 MIN	15 MIN	30 MIN	1 HR	3 HR	5 HR	10 HR	20 HR
1.60 V	8.61	5.38	4.05	2.48	1.44	0.70	0.43	0.24	0.13
1.67 V	8.10	5.20	3.90	2.37	1.42	0.65	0.43	0.24	0.13
1.70 V	7.41	4.92	3.82	2.17	1.40	0.60	0.42	0.24	0.13
1.75 V	7.28	4.76	3.69	2.07	1.37	0.58	0.41	0.23	0.12
1.80 V	6.52	4.55	3.37	1.90	1.34	0.57	0.40	0.23	0.12
1.85 V	5.75	4.33	3.02	1.75	1.30	0.56	0.39	0.23	0.12

## Constant Power Discharge Ratings - watts at 25°C

F.V / Time	5 MIN	10 MIN	15 MIN	30 MIN	1 HR	3 HR	5 HR	10 HR	20 HR
1.60 V	17.3	12.10	9.12	5.52	2.88	1.22	0.83	0.47	0.25
1.67 V	16.8	11.76	8.88	5.47	2.87	1.21	0.83	0.46	0.24
1.70 V	16.4	11.52	8.64	5.40	2.83	1.20	0.82	0.46	0.24
1.75 V	15.6	11.14	8.40	5.28	2.80	1.18	0.81	0.46	0.24
1.80 V	14.9	10.61	7.92	5.04	2.76	1.15	0.80	0.46	0.24
1.85 V	14.3	10.12	7.46	4.83	2.73	1.13	0.79	0.45	0.23



**UKAI BILBAO**  
 Ribera Elorrieta 7C  
 48015 Bilbao  
 Teléfono: 94 474 5252  
 Fax: 94 475 9710  
 e-mail: ukai@ukai.com

**UKAI BARCELONA**  
 Avda. Vallcarca 74-76  
 08023 Barcelona  
 Teléfono: 93 284 0898  
 Fax: 93 210 6765  
 e-mail: ukaibcn@ukai.com

**UKAI MADRID**  
 Avda Andalucía 2, 2ª planta local 211  
 28700 San Sebastián de los Reyes  
 Teléfono: 91 659 0328  
 Fax: 91 659 0558  
 e-mail: ukaimad@ukai.com