

Led Strips Professional Series

FU-BLF-COB4-XX-(W)X

COB LED tape light



Features

High Light efficiency design, meet new ErP regulation.

Dot free and perfectly homogeneous linear LED light line.

Immersion gold process, anti-oxidation and prevents color drift.

FPC in special design, protect the chips, strengthen the bending resistance and have a better heat dissipation.

Larger luminous area of phosphor, better luminous effect.

Ultra slim 4mm FPC, DC24V, 5cm cuttable length, 5m/pcs, SDCM<3.

5 years warranty indoor use.

* LM80 CERTIFIED:
LED LIFESPAN tested under LM80;
Expected LIFETIME of 30,000h.

FU-BLF-COB4-XX-(W)X

Professional series

COB LED tape light



COB
led

8
W/m

24V

Warranty up to
5
Years

≤800
lm/m

MacAdam
3 level
SDCM
BIN1

standard
CRI
>90

White color temperature range.



5 Max. meters in series
(one side powered)

VHB
3M

driver
NOT
included

180°

5m

✂
5cm

🕒
30.000 h

10 Max. meters in series
(two side powered)

Do not blend

ESD

Dimmable

HIGH POWER
Alu profile
required

Working
50°C
-20°C

Storage
60°C
-40°C

Features

| Part number | CCT / wavelength | Luminous intensity per m / flux | Efficiency lm / W | Energy efficiency | Ordinary strip | Strip with waterproof part number "W" suffix |
|---------------------|------------------|---------------------------------|-------------------|-------------------|----------------|--|
| FU-BLF-COB4-24-(W)X | ±2400k | ±628lm | ±79 | F → | | <p>Sin desviación de temperatura de color.</p> |
| FU-BLF-COB4-BH-(W)X | ±2700k | ±672lm | ±84 | F → | | |
| FU-BLF-COB4-BC-(W)X | ±3000k | ±700lm | ±87 | F → | | |
| FU-BLF-COB4-BN-(W)X | ±4000k | ±776lm | ±97 | F → | | |
| FU-BLF-COB4-BF-(W)X | ±6500k | ±800lm | ±100 | F → | | |

Notes



25 length models are available under request. Contact to our Sales Department.

PRODUCT SIZE

Frontal view

Units: mm

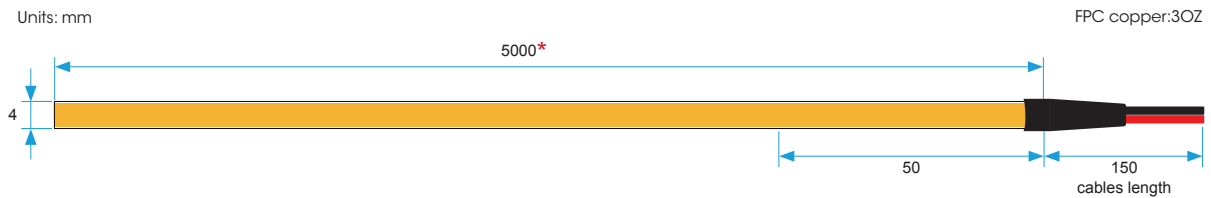

Side view

Units: mm

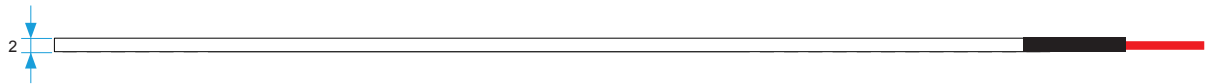

* 25 meter models for references FU-BLF-COB4-XX-X/25.

FAST CONNECTORS



Splice connector 5mm 2PIN



Connector with cables 5mm 2PIN



Jumper connector 5mm 2PIN

Attention

Scrape off 2mm of phosphor at the top end of the COB LED tape light, then connect and press the connector

INSTALLATION

Adhesive 3M VHB



LUMINOUS INTENSITY DISTRIBUTION DIAGRAM

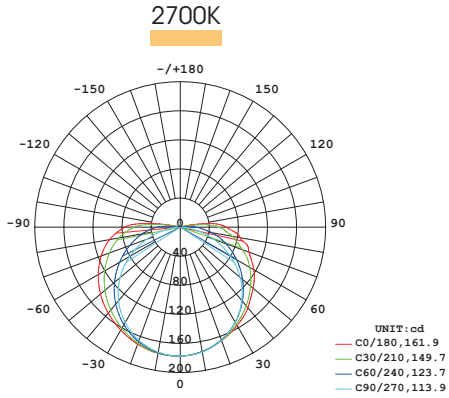

Average beam angle (50%): 137.3 deg.

Flux out: 406.6 lm

| Height | Ray, Bmax | Angle: 113.91deg | Diameter |
|--------|-----------------|------------------|-----------|
| 1m | 54.58, 177.71x | | 307.47cm |
| 2m | 13.65, 44.421x | | 614.94cm |
| 3m | 6.065, 19.741x | | 922.41cm |
| 4m | 3.411, 11.101x | | 1229.88cm |
| 5m | 2.183, 7.1071x | | 1537.35cm |
| 6m | 1.516, 4.9951x | | 1844.81cm |
| 7m | 1.114, 3.6261x | | 2152.28cm |
| 8m | 0.8529, 2.7761x | | 2459.75cm |
| 9m | 0.6739, 2.1931x | | 2767.22cm |
| 10m | 0.5458, 1.7771x | | 3074.69cm |

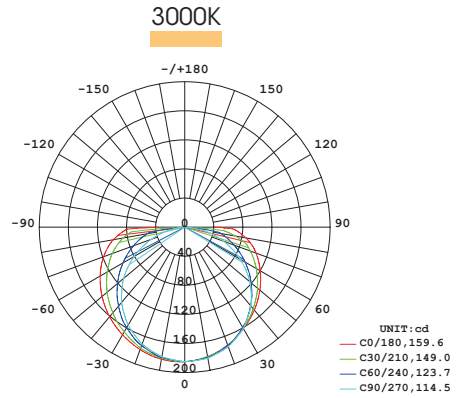

Average beam angle (50%): 136.7 deg.

Flux out: 427.3 lm

| Height | Ray, Bmax | Angle: 114.97deg | Diameter |
|--------|-----------------|------------------|-----------|
| 1m | 55.21, 185.21x | | 311.35cm |
| 2m | 13.80, 46.291x | | 622.69cm |
| 3m | 6.134, 20.571x | | 934.04cm |
| 4m | 3.450, 11.571x | | 1245.39cm |
| 5m | 2.208, 7.4061x | | 1556.74cm |
| 6m | 1.534, 5.1431x | | 1868.08cm |
| 7m | 1.127, 3.7791x | | 2179.43cm |
| 8m | 0.8626, 2.8931x | | 2490.78cm |
| 9m | 0.6816, 2.2861x | | 2802.13cm |
| 10m | 0.5521, 1.8521x | | 3113.47cm |

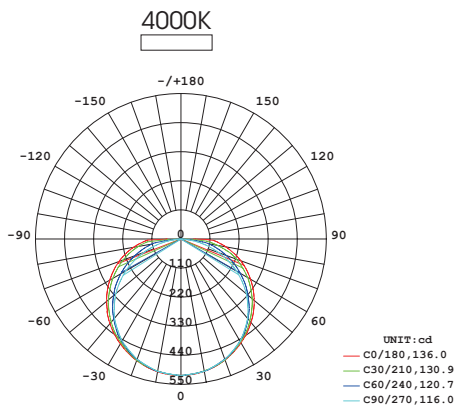

Average beam angle (50%): 125.9 deg.

Flux out: 1200 lm

| Height | Ray, Bmax | Angle: 116.07deg | Diameter |
|--------|----------------|------------------|-----------|
| 1m | 149.4, 516.31x | | 320.49cm |
| 2m | 38.85, 129.11x | | 640.99cm |
| 3m | 15.99, 57.361x | | 961.48cm |
| 4m | 9.963, 32.271x | | 1281.98cm |
| 5m | 5.736, 20.651x | | 1602.47cm |
| 6m | 3.984, 14.341x | | 1922.97cm |
| 7m | 2.927, 10.541x | | 2243.46cm |
| 8m | 2.241, 8.0661x | | 2563.96cm |
| 9m | 1.770, 6.3731x | | 2884.45cm |
| 10m | 1.434, 5.1621x | | 3204.95cm |

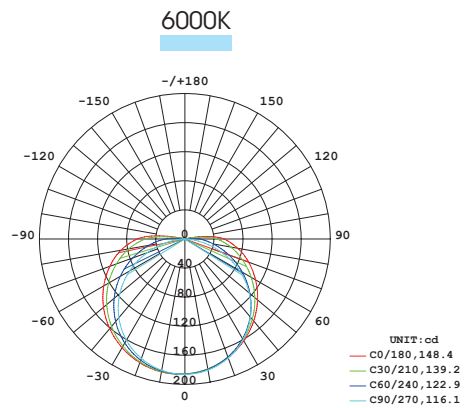

Average beam angle (50%): 131.7 deg.

Flux out: 446.2 lm

| Height | Ray, Bmax | Angle: 116.09deg | Diameter |
|--------|-----------------|------------------|-----------|
| 1m | 51.28, 186.41x | | 320.66cm |
| 2m | 12.82, 46.611x | | 641.31cm |
| 3m | 5.697, 20.721x | | 961.97cm |
| 4m | 3.205, 11.651x | | 1282.63cm |
| 5m | 2.051, 7.4581x | | 1603.28cm |
| 6m | 1.424, 5.1791x | | 1923.94cm |
| 7m | 1.044, 3.8051x | | 2244.59cm |
| 8m | 0.8012, 2.9131x | | 2565.25cm |
| 9m | 0.6330, 2.3021x | | 2885.91cm |
| 10m | 0.5128, 1.8641x | | 3206.56cm |

 **CAUTIONS**

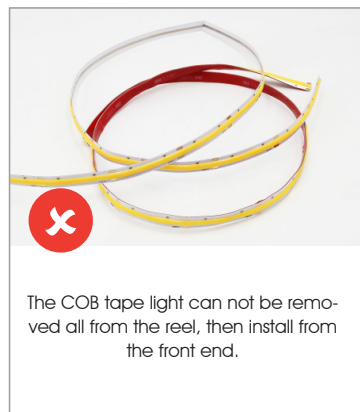
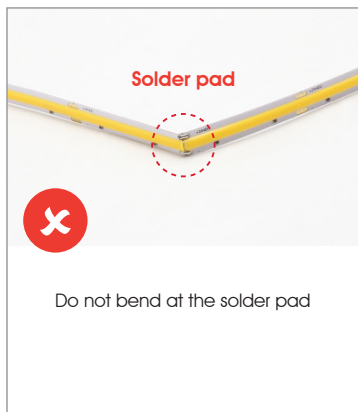
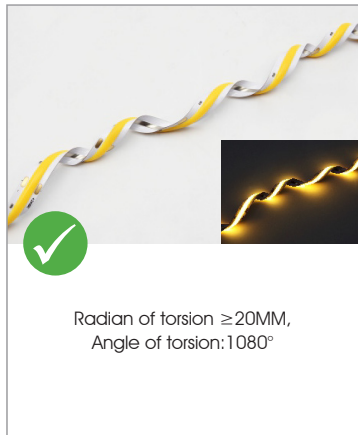
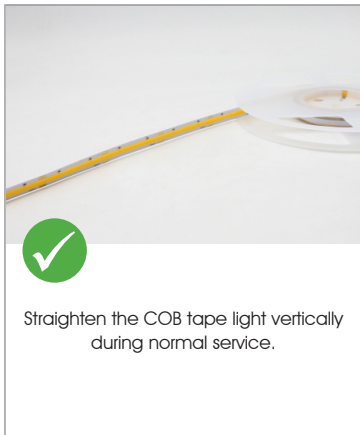

- Do not connect the low voltage LED strip 12V or 24V directly to 220V. In this case, the LEDs will be instantly destroyed!
- If LED strip with cables on both sides, please attention: when connect one side to the driver, make sure the other side cables (negative and positive) stay disconnected. Otherwise, the LED strip will be in short circuit and increase risk of damaging the strip light.
- LED strip is electrostatic and sensitive device, please wear the anti-static wrist strap or the anti-static glove when touch or use it.

PACKAGING

